



+ TUTORIALS



STRENGTHS

- > New and renovated commercial and office buildings
- > Easy to install, either indoors or outdoors, on the floor or to the ceiling
- > Flow rate up to:
 - 800 m³/hour with VMI® PRO regulation
 - 1000 m³/hour in GTC/GTB control
- > Fixed air flow rate or optional CO₂ concentration control
- > Real-time filter clogging measurement
- > Compatible with our complementary air quality sensors
- > BMS compatible
- > Easy to configure with the VMI+ mobile application. No commitment or subscription required, download free of charge from App Store or Google Play

Description	Ref. no.
Pro 1000	301.0012

DESCRIPTION

- > Aluminium-zinc double skinned housing 1 mm – M1 fire rating
- > Mineral wool insulation, 25 mm R= 0.71 m² K/W
- > Local built-in disconnection switch
- > EC type very low consumption motor
- > Fine particle filter F7 - ePM1 55% (as per standard ISO 16890)
- > Wireless pilot assistant with LCD screen
- > Fixed air flow rate
- > As an option, the air flow rate can be controlled based on the CO₂ concentration measured in real time using one or several air quality sensors (5 speeds)
- > Built-in preheating system for blown air
- > Boost mode
- > Holiday mode
- > BMS compatible via the Modbus protocol
- > Assisted configuration via the VMI+ mobile application
- > Operating history

TECHNICAL DATA

- > Minimum flow rate: 200 m³/h
- > Maximum flow rate: 800 m³/h with the VMI® PRO control unit, 1,000 m³/h with GTC/GTB control
- > Maximum motor output: 283 W
- > Rated built-in electrical heating capacity: 1800 W
- > Voltage: Single-phase 230 V - 50 Hz
- > Module rating: IPX4
- > Maximum outdoor air temperatures: -20°C / 60°C
- > Modbus RTU

DIMENSIONS

Weight: 35 kg

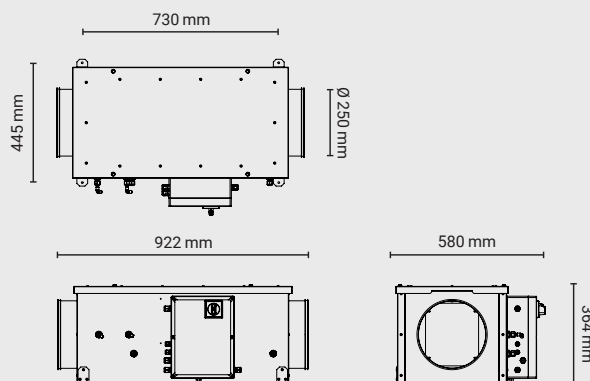

EXAMPLE OF A STANDARD SET-UP

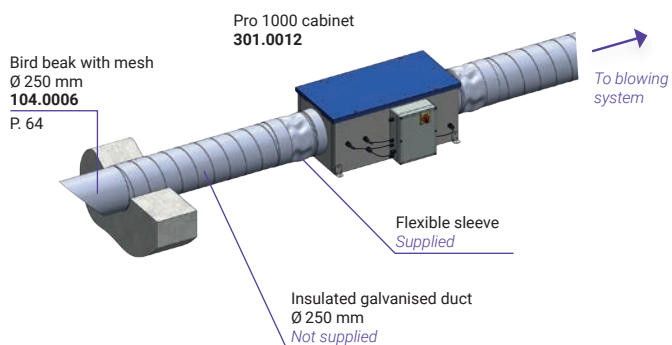



Compatible
with VMI+



Complies with
Eco-design
directive 1253/2014



SET-UP EXAMPLES

IN A SCHOOL

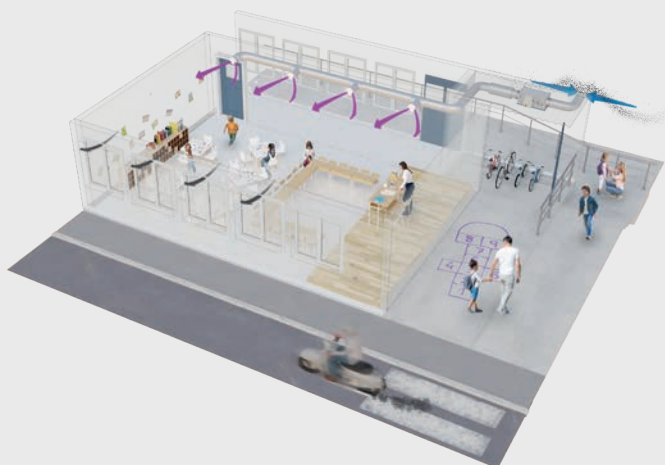

IN THE OFFICES



PERFORMANCE

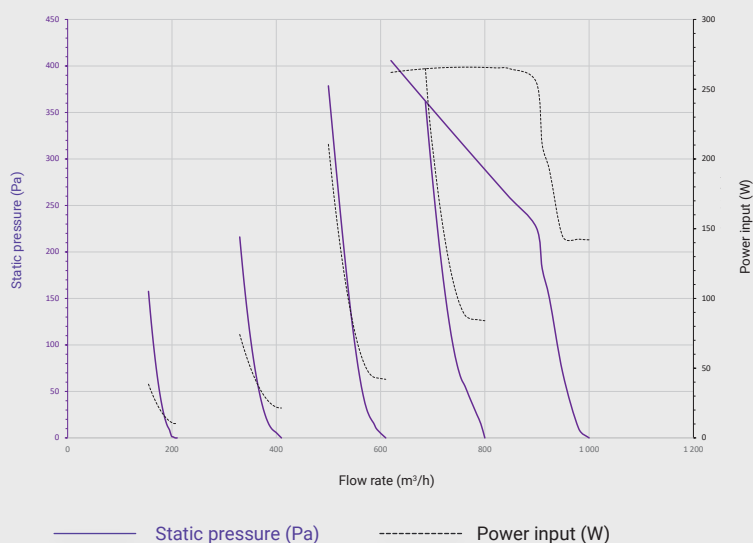

Air flow rate in m³/h	Motor rated output in W	Load loss type ⁽¹⁾ in Pa
200	11.9	8
400	30.1	30
600	69.0	72
800	137.3	129

(1) load loss calculated for the standard set-up below

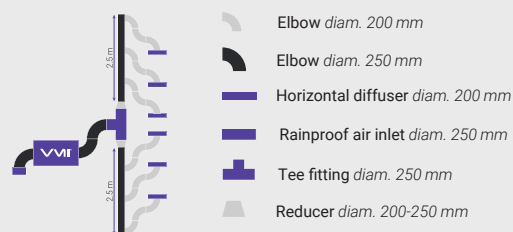

BOX CONTENTS

Description	Quantity
Pro 1000 housing	1
Fine particle filter F7 - ePM1 55%	1
Control unit - wireless	1
Silencer	4
Flexible sleeve	2

MEMO

To complete the installation, don't forget the self-regulating air outlets, the 16A circuit breaker, the power cable, the trunking...

ACCESSORIES

Description	Ref. no.	Details
Wireless air quality sensor	101.0002	P. 13
Fine particle filter F7 - ePM1 55%	700.0015	P. 59
Insulated hot water coil Ø 250 mm 7.7 kW	104.0004	P. 64
Insulated hot/cold water battery Ø 250 mm	104.0008	P. 64
Single-phase self-regulating battery Ø 250 mm - 3 kW	104.0005	P. 64
Ground-coupled heat exchanger	ON REQUEST	-
Outdoor air inlet - Bird beak with mesh Ø 250 mm	104.0006	P. 64
Silencer Ø 250 mm	104.0003	P. 64