



The Eyota 600 positive input ventilation system ensures optimal air quality in **homes up to 450 m²**. It **filters the** incoming air, removing **humidity, CO₂, and VOCs** while ensuring **thermal comfort and energy savings**. Its high-efficiency heat exchanger **recovers up to 93% of the heat from the extracted** air to warm the incoming air.

STRENGTHS

- > **Smart control and connectivity** with humidity and CO₂ sensors, remote control, and VA CONNECT mobile app.
- > **Energy savings:** heat recovery efficiency up to 93% and 100% modular bypass, active year-round
- > **Installation flexibility:** vertical or horizontal branch connections and left/right reversibility

Description	Ref. no.
Eyota 600 CO2 LH	1303.0006
Eyota 600 CO2 RH	1303.0009



DESCRIPTION

- > The housing is made of PPE with an ABS outer shell
- > 2 very low consumption EC3 motors with constant flow
- > 2 G4 pollen filters - Coarse 60% (according to ISO 16890 standard)
- > Integrated control screen
- > 4 ventilation levels: low, normal, high, intense
- > Integrated humidity, CO₂, temperature, and pressure sensors
- > Option to add up to 32 optional sensors (humidity/temperature, CO₂, and presence) to customise the installation room by room
- > Counterflow heat exchanger with up to 93% efficiency
- > 100% modular bypass
- > Integrated preheating system on the left (Eyota 600 CO2 LH) or right (Eyota 600 CO2 RH)
- > 4 top connections, 2 left connections, 2 right connections
- > Digital reversibility right/left
- > Assisted configuration via the VA CONNECT mobile app
- > 1.5 metre power cable

TECHNICAL DATA

- > Maximum flow rate: 600 m³/h
- > Maximum recommended surface area: 450 m²
- > Thermal efficiency: up to 93%
- > Maximum power: 2 x 172 W (344 W)
- > Energy rating: **A+**
- > Voltage: 230 V 50 Hz
- > Communication: RF868 MHz, RS485 input, Modbus, Bluetooth, WiFi, 5 digital inputs (reversible), 2 LS inputs, 2 0-10V inputs, LED output
- > Maximum operating temperatures: -20°C / 40°C

DIMENSIONS

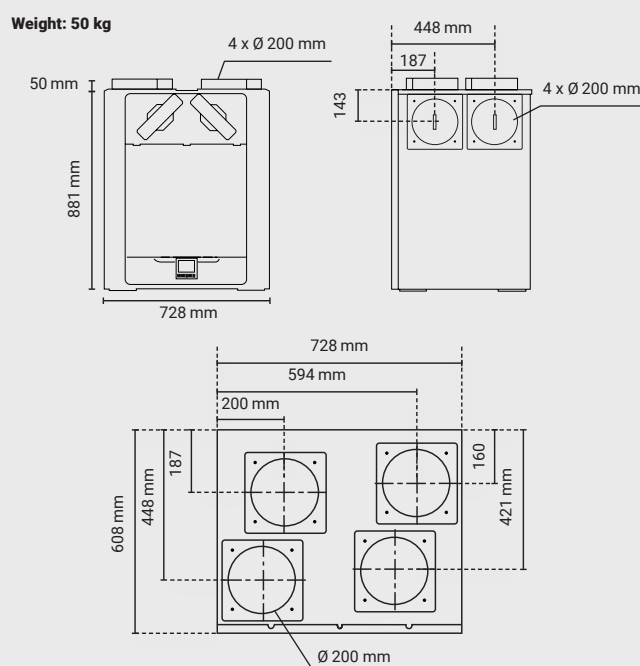

LEFT

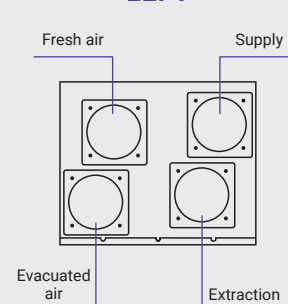

RIGHT

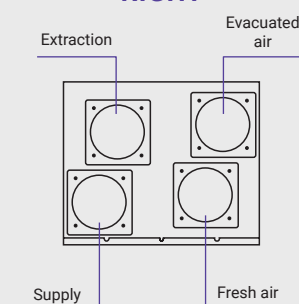



Complies with Eco-design
directive 1253/2014
and energy labelling
directive 1254/2014

EXAMPLES OF A STANDARD SETUP

VERTICAL SETUP

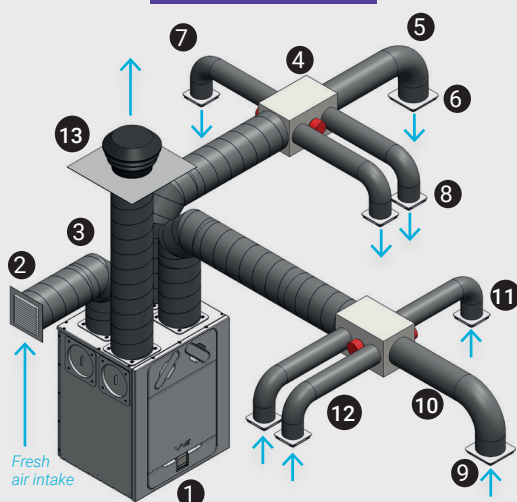

- 1 Housing Eyota 600 CO2 LH - **1303.0006**
Eyota 600 CO2 RH - **1303.0009**
- 2 External rainproof grille - *Not supplied*
- 3 Duct Ø 200 mm in PEE, aluminium or PVC insulated - *Not supplied*
- 4 Distribution plenum - *Not supplied*
- 5 Semi-rigid insulated duct to lounge, living room Ø 125 mm - *Not supplied*
- 6 Supply grille Ø 125 mm - 102.0017
- 7 Semi-rigid insulated duct to bedrooms Ø 80 mm - *Not supplied*
- 8 Supply grilles Ø 80 mm - 102.0016
- 9 Extraction grille Ø 125 mm - 102.0017
- 10 Semi-rigid insulated duct to kitchen Ø 125 mm - *Not supplied*
- 11 Extraction grilles Ø 80 mm - 102.0016
- 12 Semi-rigid insulated duct to bathroom/toilet Ø 80 mm - *Not supplied*
- 13 Roof outlet Ø 200 mm - *Not supplied*

HORIZONTAL SETUP

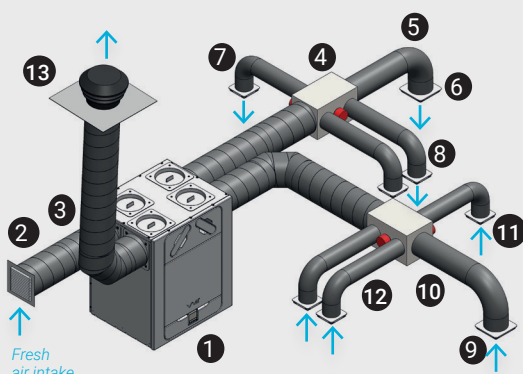

BOX CONTENTS

Description	Quantity
Eyota 600 CO2 module	1
Pollen filter G4 - Coarse 60%	2
Wall-mounting bar	1

PERFORMANCE

Air flow rate in m³/h	Pressure drop in Pa	Power input in W	SFP in W/m³h
450	100	133	0.30
500	150	173	0.35
550	150	207	0.38
600	200	267	0.44

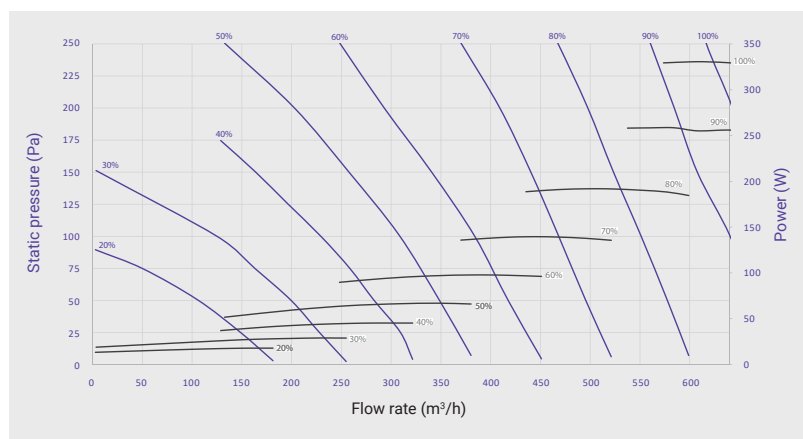

Air flow rate in m³/h	Pressure drop in Pa	Sound power of supplied air in dB(A) ⁽¹⁾	Sound power of extracted air in dB(A) ⁽¹⁾	Radiated sound power in dB(A) ⁽¹⁾	Radiated sound pressure in dB(A) 1m ⁽¹⁾
350	50	64.2	48.1	52.1	44.8
450	100	69.3	51.3	59.4	51.5
550	150	72.6	54.8	60.2	52.2
600	200	74.8	58.6	73.0	63.9

⁽¹⁾ Sound power level determined according to the BS EN 13141-7:2021 standard, frequencies from 63 Hz to 8 kHz. Enclosure radiation and sound power level of the duct in LwA (A-weighted overall sound power level in dB(A), corrected for background noise)

ACCESSORIES

Description	Ref. no.
2 pollen filters G4 - Coarse 60%	1304.0055
1 pollen filter M5 - ePM10 50%	1304.0056
1 fine particle filter F7- ePM2.5 70%	1304.0057
Additional connection Ø 200 mm	1304.0058
Connection with foam Ø 200 mm	1304.0059
4-position wireless control - batteries - SSU-B - white	1304.0070
4-position wireless control - 230 V - SSU-R - white	1304.0074
4-position wired control - 230 V - SSU-R - white	1304.0075
Wireless temperature/humidity sensor - batteries - white	1304.0067
Temperature/humidity sensor RS485/RF868 - 230 V - white	1304.0066
Temperature/humidity sensor - 0-10 V - white	1304.0065
CO ₂ sensor RS485/RF868 - 230 V - white	1304.0068
CO ₂ sensor - 0-10 V - white	1304.0064
Presence sensor RS485 & RF868 - 230 V - white	1304.0071